

● FEATURES (特性)

The wide band choke cores mainly used in the PC boards to filters the EMI from the outside.

寬頻的扼流綫圈主要應用在主機板上用以防止外來的電磁波干擾

Ferrite core construction of low cost

低成本之鐵氧氣體結構



● APPLICATIONS (用途)

Personal Computer and electronic products.

電腦及電子產品

● PART NUMBERING SYSTEM (品名系統)

CKB R6H - 2Ts B

4 PACKING CODE 包裝
B:In Bulk (散裝)

3 INDUCTANCE 電感值

2 DIMENSIONS 尺寸

1 SERIES NAME 品名

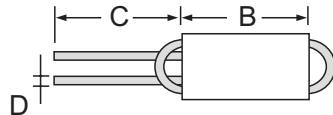
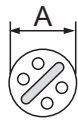

2 Ts

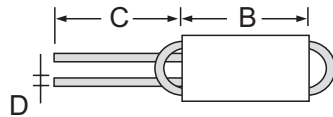

3 Ts

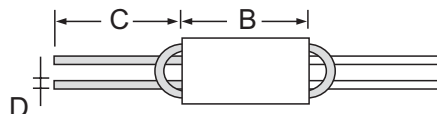

1.5Ts+1.5Ts

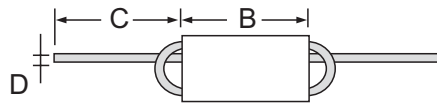

2.5 Ts

Unit in mm

Type (型式)	ϕA ± 0.5	B ± 0.5	C (min)	ϕD ± 0.05
CKB R6H - 1.5 Ts	6.0	10.0	15.0	0.5/0.6
CKB R6H - 2.5 Ts	6.0	10.0	15.0	0.5/0.6
CKB R6H - 3.0 Ts	6.0	10.0	15.0	0.5/0.6
CKB R6H - 1.5+1.5 Ts	6.0	10.0	15.0	0.5/0.6

△ Special inquiries besides the above common used types can be met on your requirement.
超出以上規格的特殊要求也可滿足